

melvyn
Danes
ESTATE AGENTS

Aqueduct Road

Shirley

Offers Around £165,000

Description

Everseigh Court is situated on the junction with Green Lane and Aqueduct Road within a location that feels open and spacious. The development was constructed by Bryant Homes in 2005 and has been well maintained throughout its lifetime and is secured from the roadside behind remote control electrically operated gates that open into the residents and visitor parking area which is surrounded by mature well tended grounds.

Conveniently situated for many local amenities in the area including Shirley railway station which offers commuter services on the Birmingham to Stratford-upon-Avon line, there are local shops sited in Colebrook Road and Haslucks Green Road. Local bus services operate in the area providing access to the City of Birmingham, Solihull Town centre and surrounding areas.

We are advised that the property is situated within the Light Hall Senior School catchment, and is conveniently situated for Mill Lodge Junior and Infant School located nearby in Aqueduct Road. Also available in the area are Burman Infant School and Haslucks Green Junior School. On the main Stratford Road will also be found Our Lady of the Wayside Roman Catholic Nursery, Junior and Infant School. Education facilities are subject to confirmation from the Education Department.

Along the A34 Stratford Road is an excellent choice of shops including the new Parkgate Shopping centre including Asda which are augmented by the Superstores sited on the Retail Park in Marshall Lake Road. There is a thriving business community in Shirley which extends south down the A34 to the Cranmore, Widney, Monkspath and Solihull Business Parks, and on to the Blythe Valley Business Park which is sited on the junction of the M42 motorway. A journey down the motorway will bring you to the junction with the A45, close to which are the National Exhibition Centre and Birmingham International Airport and Railway Station.

An ideal location for this top floor apartment which is particularly well proportioned and really does need to be viewed to be appreciated. Making an ideal first purchase or investment - the vendor is also offering the furnishings and appliances available to any interested party.



Accommodation

SECURE PARKING AREA

COMMUNAL ENTRANCE

RECEPTION HALLWAY

STORAGE CUPBOARD

OPEN PLAN BREAKFAST

KITCHEN

16'11" x 8'6" (5.16m x 2.59m)

LIVING AREA

13'2" x 11'2" (4.01m x 3.40m)

DOUBLE BEDROOM

12'1" x 11'2" (3.68m x 3.40m)

BATHROOM

COMMUNAL GARDENS

AGENTS NOTE

The management of the development do exclude pets that may cause a nuisance within the development and the parking of commercial vehicles is prohibited in the parking area

TENURE: We are advised that the property is Leasehold with approximately 105 years remaining on the lease and is subject to a current annual ground rent of £150. There is a service charge of approximately £1200 which we are awaiting confirmation of from our seller.

BROADBAND: We understand that the standard broadband download speed at the property is around 5 Mbps, however please note that results will vary depending on the time a speed test is carried out. The estimated fastest download speed currently achievable for the property post code area is around 1000 Mbps. Data taken from checker.ofcom.org.uk on 18/08/2025. Actual service availability at the property or speeds received may be different.

MOBILE: We understand that the property is likely to have/has limited current mobile coverage dependant on the provider (data taken from checker.ofcom.org.uk on 18/08/2025). Please note that actual services available may be different depending on the particular circumstances, precise location and network outages.

CONSUMER PROTECTION FROM UNFAIR TRADING REGULATIONS 2008: These particulars are for general guidance only and are based on information supplied and approved by the seller. Complete accuracy cannot be guaranteed and may be subject to errors and/or omissions. They do not constitute representations of fact or form part of any offer or contract. Any Prospective Purchaser should obtain verification of all legal and factual matters and information from their Solicitor. Licensed Conveyancer or Surveyors as appropriate. The agent has not sought to verify the legal title of the property and the buyers must obtain verification from their solicitor. Photographs are provided for illustrative purposes only and the items shown in these are not necessarily included in the sale, unless specifically stated. The agent has not tested any apparatus, equipment, fixtures, fittings or services mentioned and do not by these Particulars or otherwise verify or warrant that they are in working order.

MONEY LAUNDERING REGULATIONS: Under anti-money laundering legislation, we are obliged to confirm the identity of individuals and companies and the beneficial owners of organisations and trusts before accepting new instructions, and to review this from time to time. To avoid the need to request detailed identity information from intending purchasers, we may use approved external services which review publicly available information on companies and individuals. Any purchaser who has a provisional offer accepted via this company will be liable to pay a purchase administration fee of £25 inclusive of VAT to cover these checks. However, should those checks, for any reason, fail adequately to confirm identity, we may write to you to ask for identification evidence. If you do not provide satisfactory evidence or information within a reasonable time, we may have to stop acting for you and we would ask for your co-operation in order that there will be no delay in agreeing the sale.

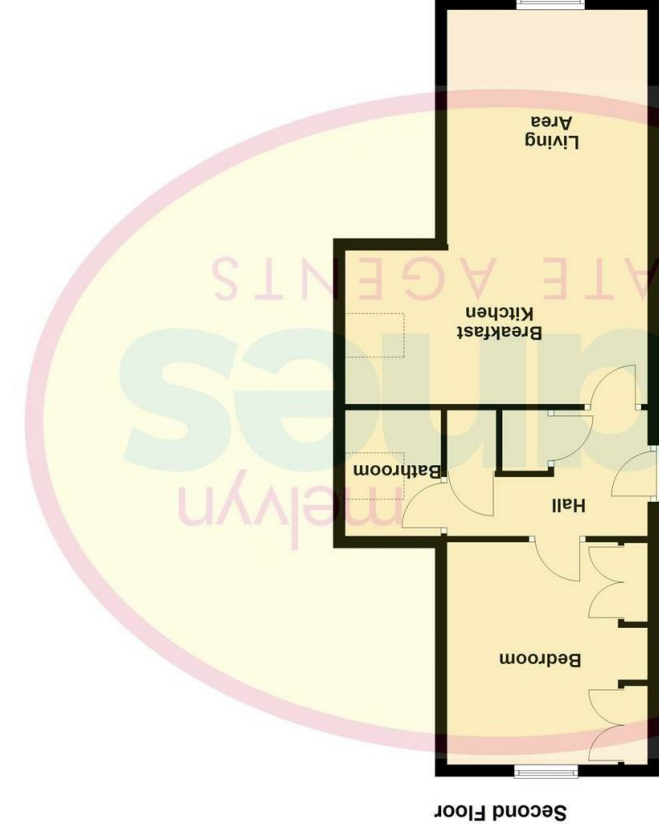
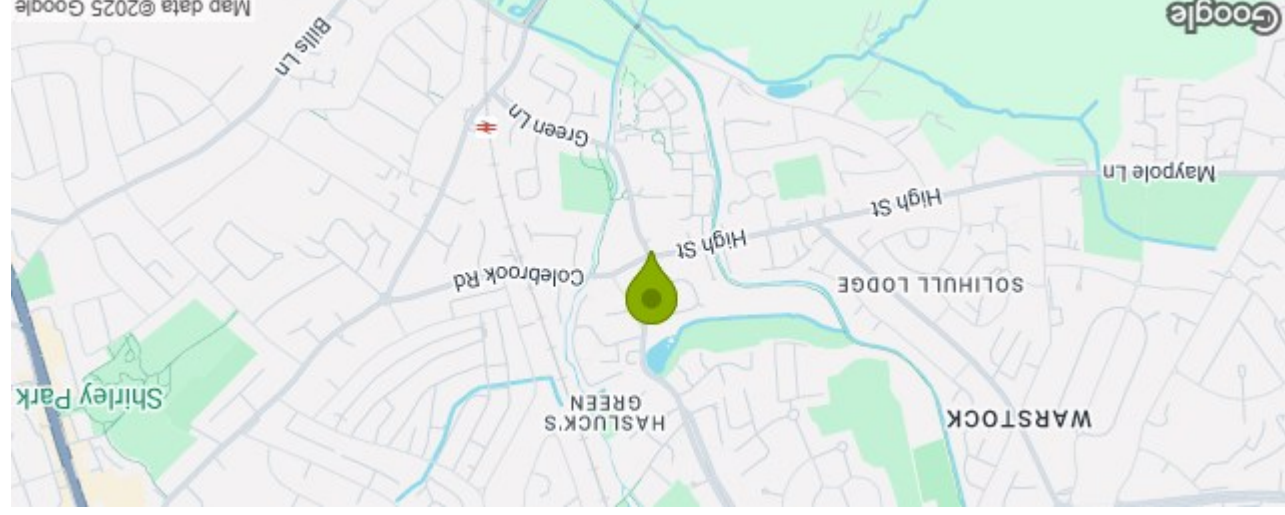

**18 Eversleigh Court Aqueduct Road Shirley Solihull B90 1BU
Council Tax Band: C**

Energy Efficiency Rating	
Potential	73
Current	73
Very energy efficient - lower running costs	
A	(92 plus)
B	(81-91)
C	(69-80)
D	(55-68)
E	(39-54)
F	(21-38)
G	(1-20)
Not energy efficient - higher running costs	
EU Directive 2002/91/EC	
England & Wales	

Please note that all measurements and floor plans are approximate and quoted for general guidance only and whilst every attempt has been made to ensure accuracy, they must not be relied on and do not form part of any contract.